



LEYENDA DE ALUMBRADO PUBLICO			
	SENTIDO DE CIRCULACION		SEÑAL INDICACION DE DIRECCION PROHIBIDA

CALLE CRISTOBAL COLON

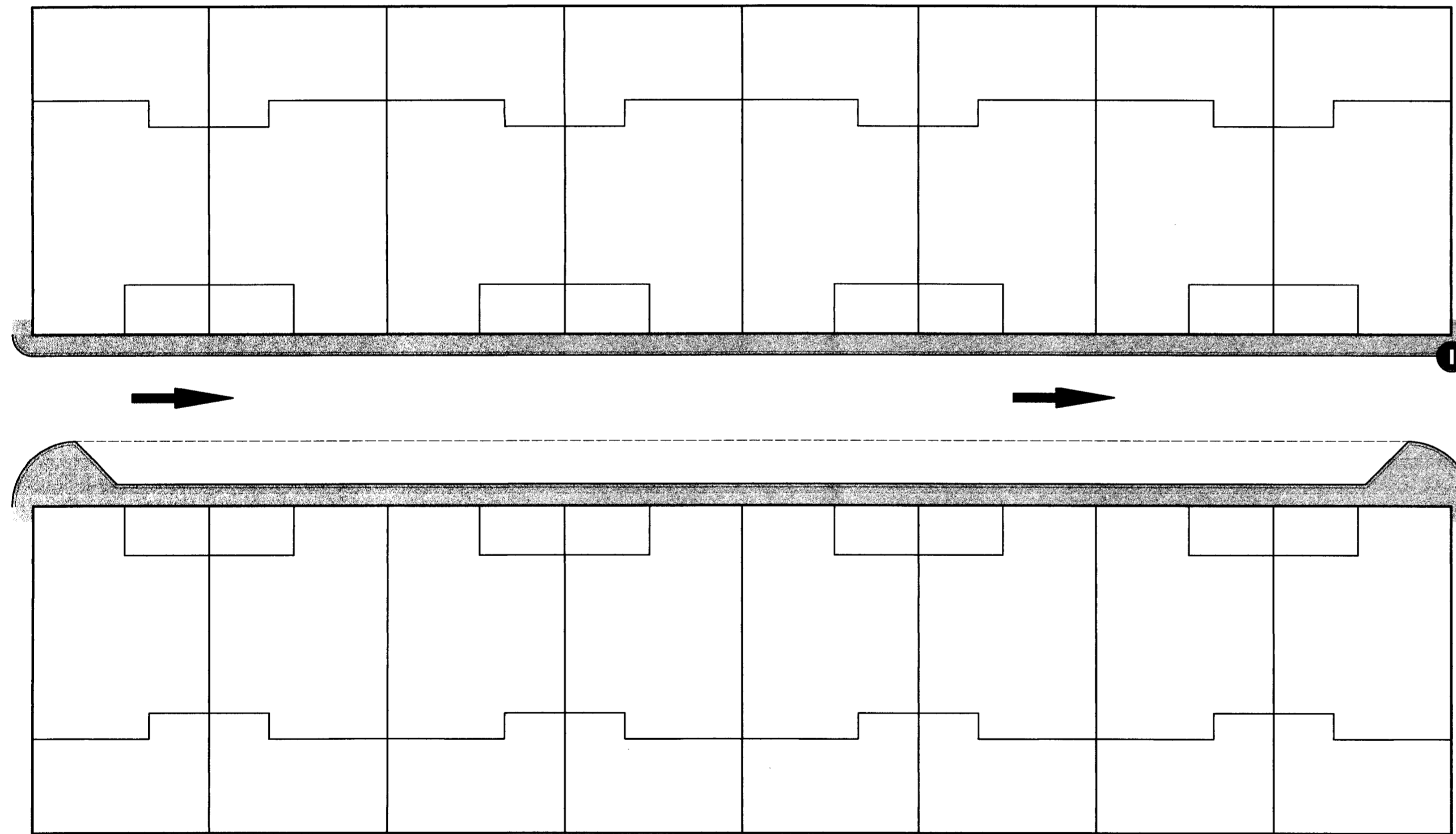

CALLE RAMBLA

PLANTA GENERAL

ESTUDIO DE DETALLE: APERTURA DE VIAL

EMPLAZAMIENTO:

C/ CRISTOBAL COLON Y C/ RAMBLA
MOTILLA DEL PALANCAR

-CUENCA-

MAYO-2005

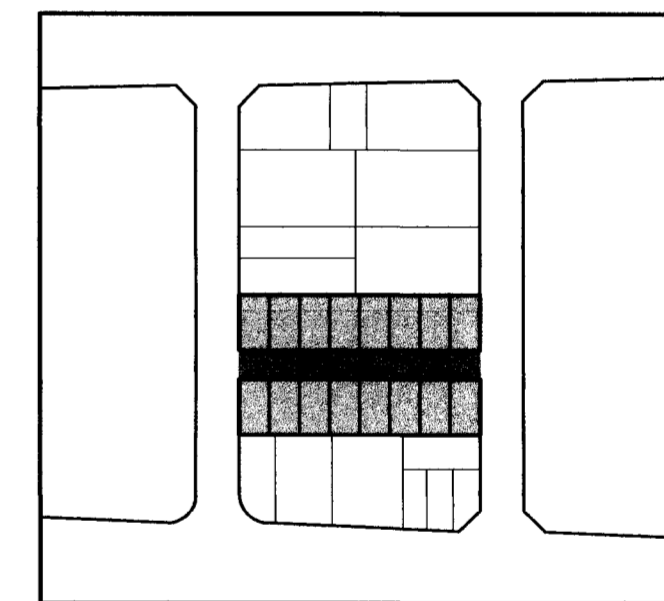

ESCALA 1/200

SEÑALIZACION

07

PROMOTORES:

PROMOCIONES Y C. IGUALADA, S.L.

ARQUITECTAS:

MARI CARMEN NAVARRO BALLESTEROS
MARIA JESUS NAVARRO BALLESTEROS

Two handwritten signatures are present in the bottom right corner of the page, corresponding to the architects listed in the text above.