

SECCION TRANSVERSAL

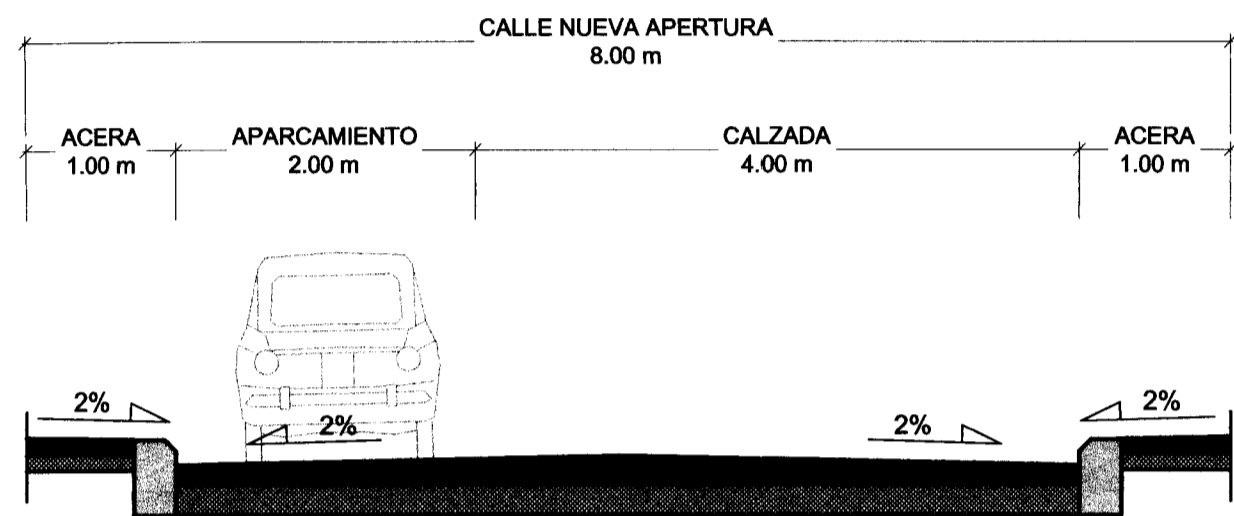

SECCION

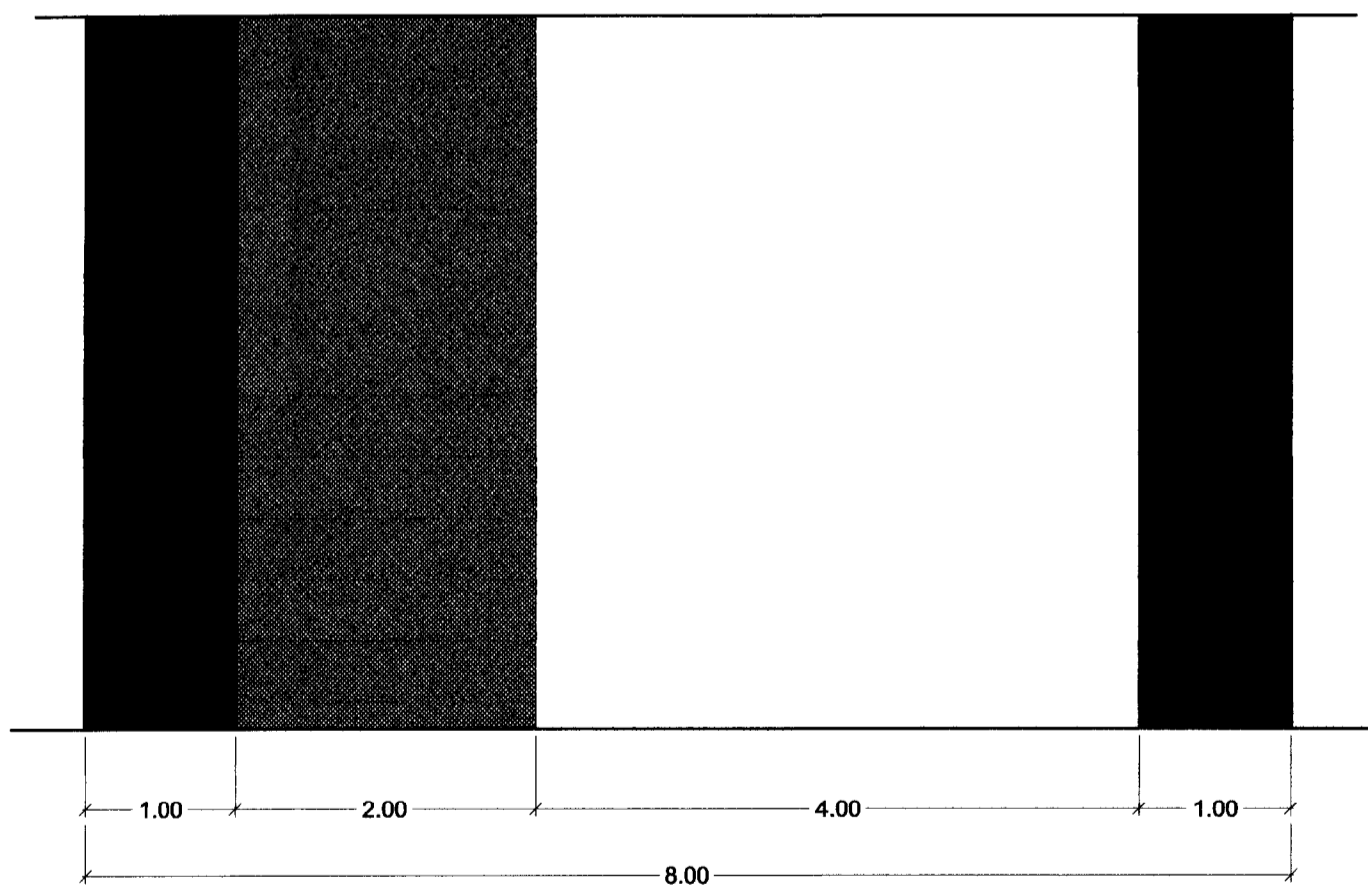

PLANTA

ESCALA 1/50

DETALLE DE PAVIMENTACION

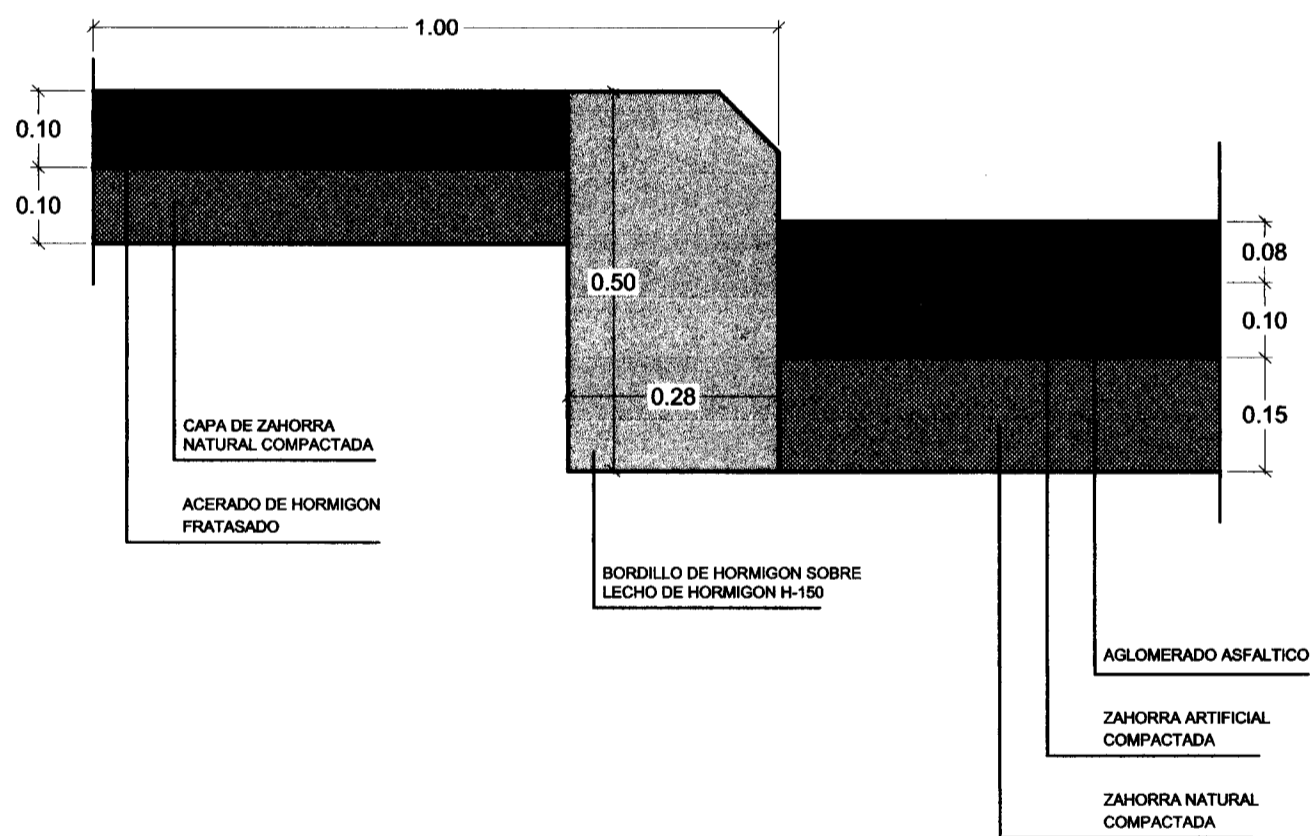

ESCALA 1/10

ESTUDIO DE DETALLE: APERTURA DE VIAL

EMPLAZAMIENTO:

C/ CRISTOBAL COLON Y C/ RAMBLA
MOTILLA DEL PALANCAR

-CUENCA-

MAYO-2005

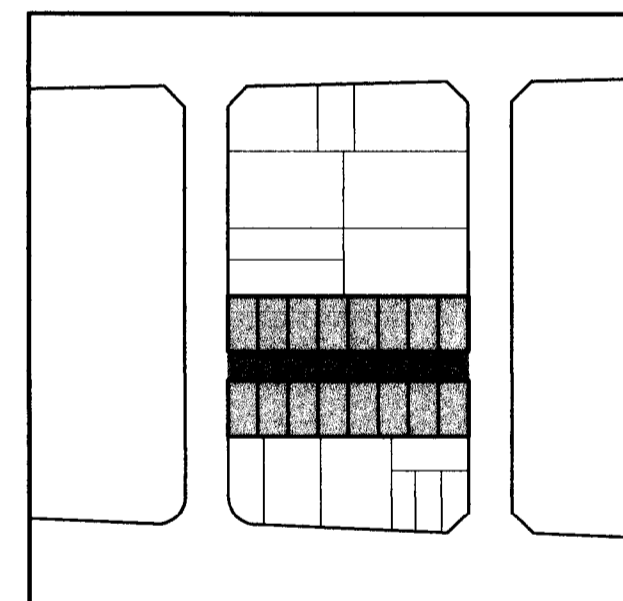

ESCALA 1/50 Y 1/10

SECCION TRANSVERSAL Y DETALLE

03

PROMOTORES:

PROMOCIONES Y C. IGUALADA, S.L.

ARQUITECTAS:

MARI CARMEN NAVARRO BALLESTEROS
MARIA JESUS NAVARRO BALLESTEROS